



## Digital HD camcorder

MD 86066

English



### 3. Switching on the camera

Proceed as follows to start the camcorder:

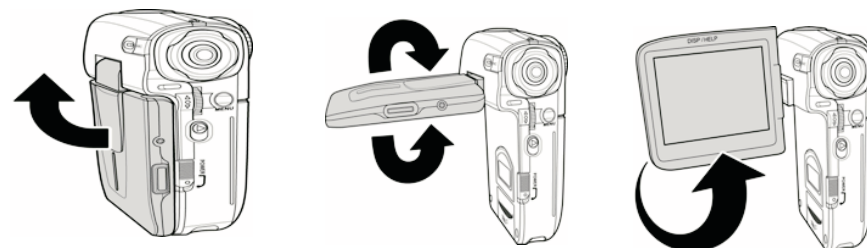

- ▶ Open the LC-display as shown, through 90°. Now turn the display in the desired direction.
  - ▶ Press the On/Off button, to switch the camcorder on.
  - ▶ The ON indicator lights up green and the display switches on.
  - ▶ Press the On/Off button to switch the camcorder off.
  - ▶ The ON indicator goes out.
- Make sure that you switch the camera off after use, to avoid consuming unnecessary energy.

### 4. Insert camcorder in underwater casing

- ▶ Push the catch of the lock upwards, as shown, and snap the lock open

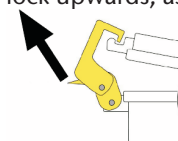

- ▶ Open the casing and lay the camcorder in the casing in "ON" mode, as shown.



Take care to ensure that the carrying strap does not become jammed between the yellow rubber seal and the casing lid. This results in a leaking casing.

Ensure that you do not submerge the camera by more than 5 metres.

### 1. First steps

Please find detailed installation instructions on the enclosed CD. With the free Adobe Acrobat Reader® software, you can display and print Adobe PDF files:

It is essential to read the instructions, which are enclosed in digital form with your camera.

The camera is for private use only and not for use in a heavy industrial business.

### 2. Inserting the batteries

In order to insert the four AAA/LR03 batteries supplied, you must proceed as follows: Open the battery compartment lid, Insert the batteries as illustrated and close the battery compartment lid.



Always observe the correct polarity. Take care to ensure that the plus (+) and minus (-) poles are correctly inserted, in order to avoid short circuits.

Use only LR03/AAA batteries.

#### 2.1 Inserting the SD/SDHC memory card

- Open the LC-display, as shown below, and open the SD/SDHC card compartment
- Insert the SD/SDHC card into the card slot, as illustrated, Close the card compartment as shown.

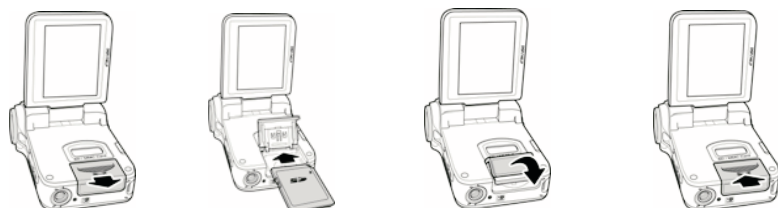

### Switching the operating mode

Your camcorder gives you three functions in one handy device. You can select the following modes by turning the mode selector switch:

- |   |                 |            |
|---|-----------------|------------|
| 1 | Movie mode      |            |
| 2 | Photo mode      |            |
| 3 | Audio mode      |            |
| 4 | System settings | <b>SET</b> |

#### System settings

In order to make the desired adjustments to the system settings (such as date or time), proceed as follows:

- ▶ Switch the camcorder on.
  - ▶ Turn the mode switch to SET.
- The System Settings menu (setup) appears.
- ▶ Turn the scroll wheel until the "Date/Time" entry is highlighted and confirm by pressing the scroll wheel.
  - ▶ Press the Right/Left navigation pad to reach the desired field (year/month/day/hour/minute/second).
  - ▶ Set the desired data by pressing the Up/Down navigation pad.
  - ▶ Press the scroll wheel to make the changes.

Details on performing the individual settings can be found in the operating instructions.

- In order to achieve the best possible image quality in playback, heed the following instructions:
- Using an HDMI cable, connect your camera to a television set with a digital connection, to take advantage of purely digital transfer and the higher resolutions of modern TV sets.
- As long as the camera is connected to a TV set, the LC monitor is switched off.
- You cannot photograph anything at a higher resolution, as long as the camera is connected to a television set.



## Recording films

To record films with your camcorder, proceed as follows:

- ▶ Switch the camcorder on.
- ▶ By turning the scroll wheel up/down, select the desired detail.
- ▶ Press the shutter release to start recording .
- ▶ In order to stop recording, press the shutter release again.
- ▶ To record films at close range activate the macro function as described in the operating instructions.

## Making films under water

Proceed as follows to make films underwater:

- ▶ Place the operational camcorder with the display extended into the case and close it.
- ▶ Use the "T" and "W" buttons to set the desired zoom factor.
- ▶ Press the shutter release  to start recording.
- ▶ In order to stop recording, press the shutter release again.

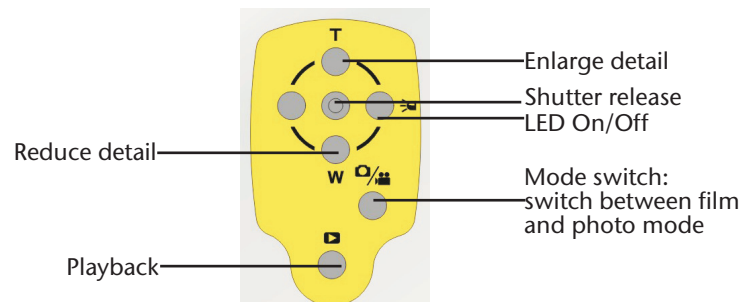

The operating LED lights up red.

Appliance overview in underwater casing:



## Playing back films under water

Proceed as follows to play back films under water:

- ▶ Press the playback button .
- ▶ With the Right/Left navigation pad, select the film which you want to watch.
- ▶ Press the shutter release  to start playback.

## Taking photos

To take photos with your camcorder, proceed as follows:

- ▶ Switch the camcorder on.
- ▶ By turning the scroll wheel up/down, select the desired detail.
- ▶ Press the shutter release to start recording .

To record films at close range activate the macro function as described in the operating instructions.

## Taking photos under water

Proceed as follows to take photos under water:

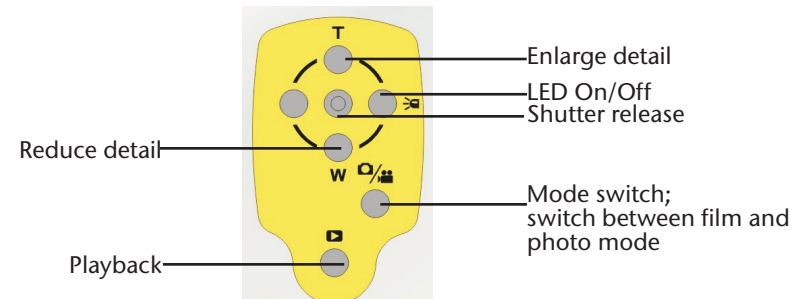

- ▶ Place the operational camcorder with the display extended into the case and close it.
- ▶ Use the "T" and "W" buttons to set the desired zoom factor.
- ▶ Press the shutter release to start recording .

Appliance overview in underwater casing:



## Playing back photos under water

Proceed as follows to play back photos under water:

- ▶ Press the playback button .
- ▶ With the Left/Right keys, select the image you want to look at or press the shutter release  button to access miniature image mode.

## Safety instructions

- Attention: Children must only be permitted to use the device without supervision if sufficient instructions that will put the child in a position to use the device safely and to be able to understand the dangers of incorrect use have been given to the respective child.
- Keep the packaging out of the reach of children. There is a risk of suffocation..

## Proper use

- The camera is intended for taking pictures in digital format. If the camera is in the closed underwater casing, you can also take underwater pictures.
- Do not operate the camera either in extreme heat or extreme cold.
- The camera is not suited to operation in extreme conditions.
- The camera is for private use only and not for use in a heavy industrial business

## Warnings

- In order to avoid injury, please heed the following warnings while using the product:
  - Do not trigger the flash too close to the eyes. In this case, damage can be caused to the eyes of the person being photographed.
  - Keep at least 1m away from children when you are working with the flash.
  - Do not place the camera strap round the neck. If the strap is placed inadvertently around the neck there is a risk of choking.
  - Do not open or dismantle the camera. Dismantling the camera constitutes a risk of high-voltage electric shock. Only expert personnel should undertake internal component tests, modifications and repairs. Take the product to an authorised Service Centre for testing
  - If you are not going to use the camera for a period of time, remove the batteries to prevent leakage.
  - The camera must not be exposed to either drips or spray, unless it is in the underwater casing. Do not place any objects filled with liquids (e.g., vases) on the camera.

## Handling with batteries

- Batteries may contain combustible materials. If not properly handled, batteries may leak, heat up intensely, ignite or even explode, which could result in damage to your camera and your health.
- Please follow the following instructions at all costs:
  - Keep children away from batteries.
  - If batteries are swallowed, consult your doctor immediately.
  - Never charge batteries (unless it is expressly specified).
  - Never empty the batteries by means of high power output.
  - Never short-circuit the batteries.
  - Never expose the batteries to excessive heat, such as from sunshine, fire or similar
  - Do not dismantle or warp the batteries. Your hands or fingers could be injured or battery fluid could come into contact with your eyes or skin. If this should happen, rinse the affected parts with a large quantity of clean water and inform your doctor immediately.
  - Avoid hard knocks and vibrations.
  - Always observe the correct polarity.
  - Take care to ensure that the plus (+) and minus (-) poles are correctly inserted.
  - Do not mix up new and old batteries or different types of battery. This could cause your camera to malfunction. In addition, the weaker batteries would discharge too much.
  - Remove used batteries from the camera immediately.
  - Remove the batteries from the appliance if you do not intend to use it for a long period of time.
  - Immediately replace all used batteries in a camera with new batteries of the same type.
  - Insulate the battery contacts with an adhesive strip, if you wish to store or dispose of the batteries.

**MEDION®**

Medion Electronics Ltd.  
120 Faraday Park, Faraday Road, Dorcan  
Swindon SN3 5JF, Wiltshire  
United Kingdom  
hotline number: 0871 37 61 020  
fax number: 01793 715716

<http://www.medion.co.uk>